

Ground Flat, 5 Glensdale Road

SE4 1UE

Application No. DC/21/123314

Demolition of rear garden wall to create a parking space and other works to improve the garden at Ground Floor Flat, 5 Glensdale Road SE4.

This presentation forms no part of a planning application and is for information only.





Site Location Plan



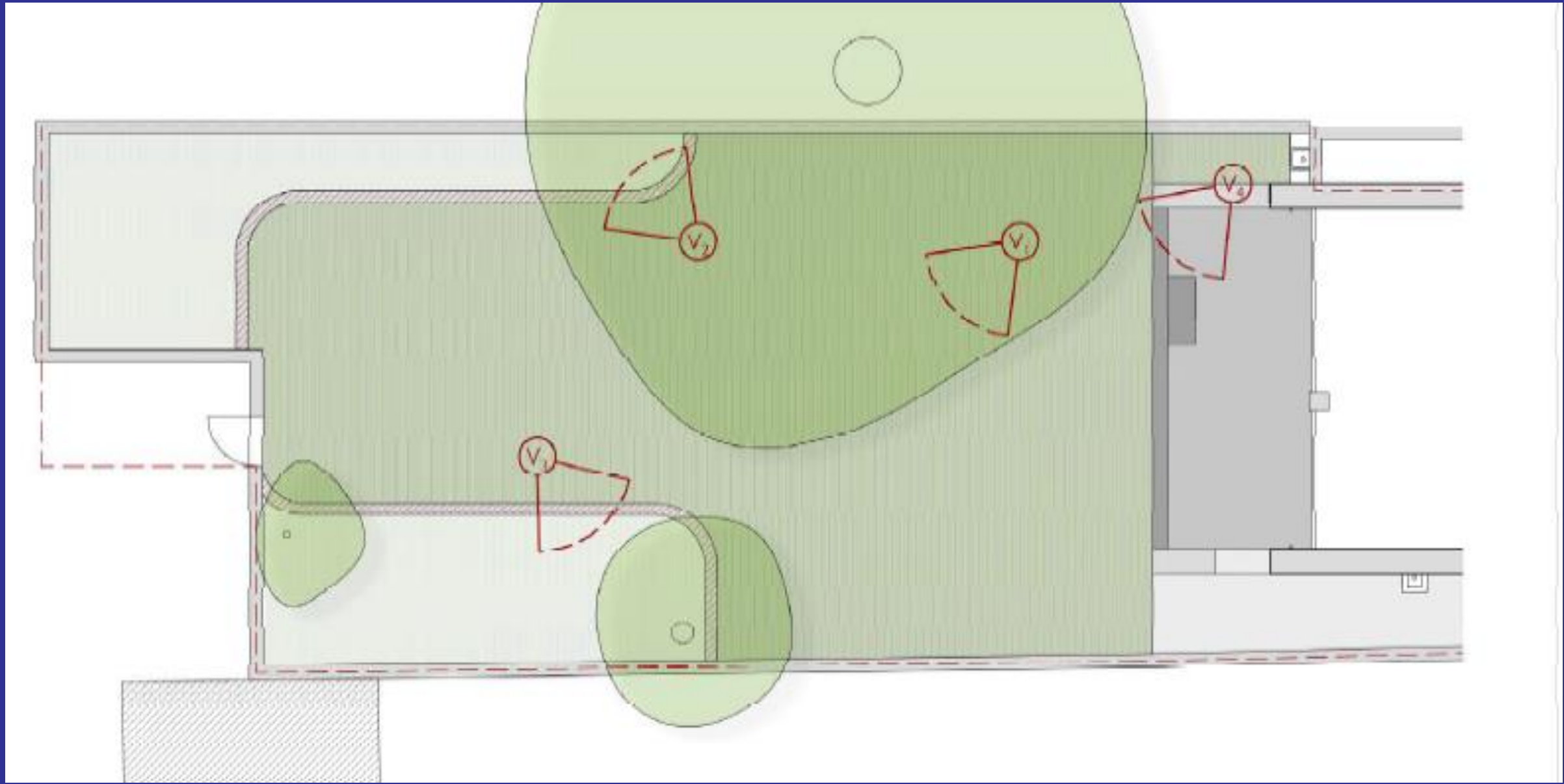

Self-seeding planting within gravel



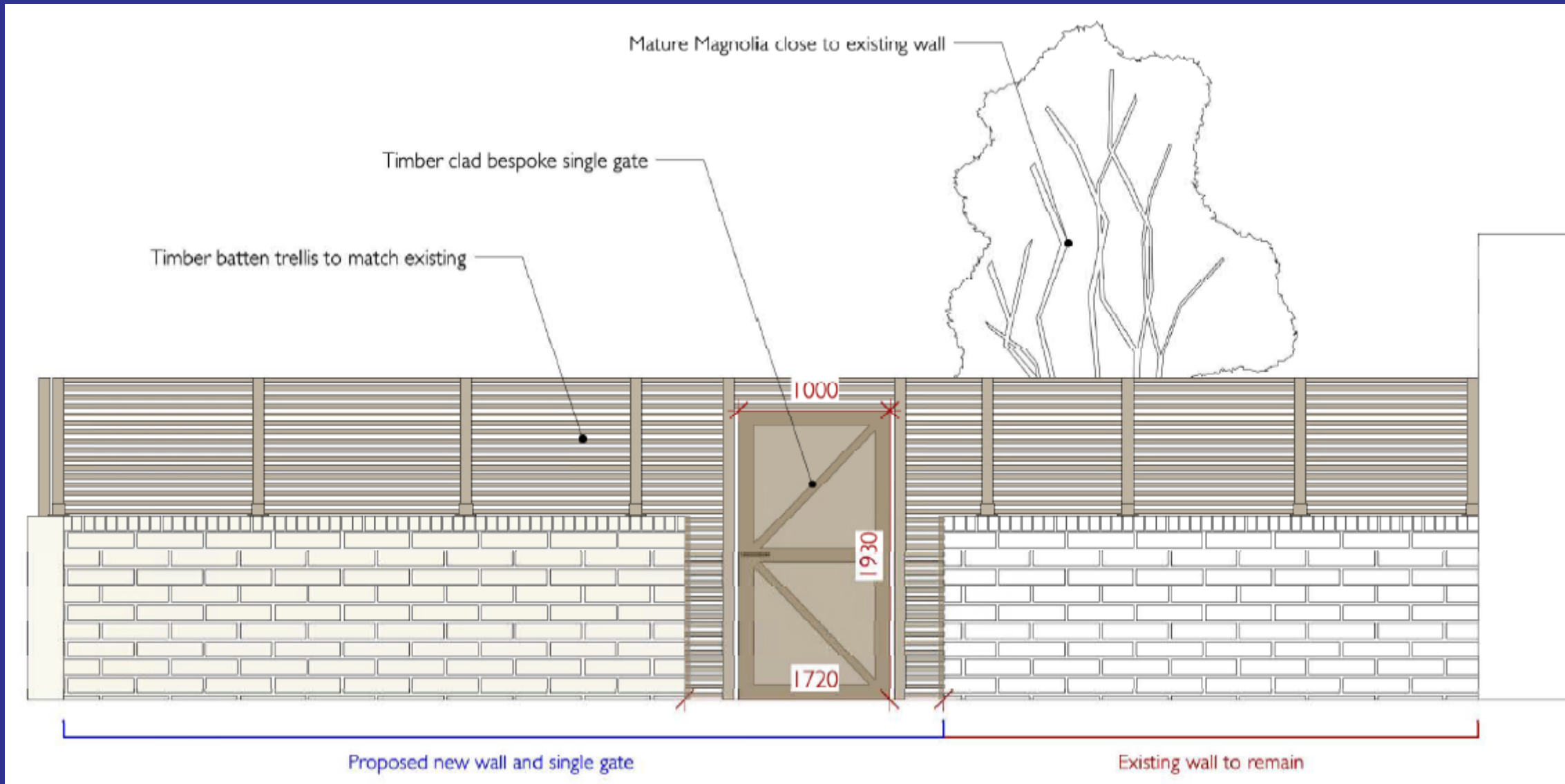

Key planning considerations

- Principle of Development
- Urban Design and Heritage Impact
- Impact on Adjoining Properties
- Transport
- Sustainable Development
- Natural Environment

